



US008348128B2

(12) **United States Patent**
Poo et al.

(10) **Patent No.:** **US 8,348,128 B2**
(45) **Date of Patent:** **Jan. 8, 2013**

(54) **ANASTOMOSIS SYSTEM AND METHOD**

(75) Inventors: **Ramon E. Poo**, Miami, FL (US);
Andreas G. Tzakis, Coconut Grove, FL (US)

(73) Assignees: **Biorep Technologies, Inc.**, Miami, FL (US); **University of Miami**, Miami, FL (US)

(*) Notice: Subject to any disclaimer, the term of this patent is extended or adjusted under 35 U.S.C. 154(b) by 285 days.

(21) Appl. No.: **12/616,396**

(22) Filed: **Nov. 11, 2009**

(65) **Prior Publication Data**

US 2011/0108602 A1 May 12, 2011

(51) **Int. Cl.**
A61B 17/115 (2006.01)

(52) **U.S. Cl.** **227/179.1**; 227/175.1; 227/176.1; 411/457; 606/139; 606/142; 606/153

(58) **Field of Classification Search** 227/175.1, 227/176.1; 411/457; 606/139, 142, 153
See application file for complete search history.

(56) **References Cited**

U.S. PATENT DOCUMENTS

1,151,300 A * 8/1915 Soresi 604/7
4,624,257 A * 11/1986 Berggren et al. 606/153

6,736,825 B2	5/2004	Blatter et al.	
6,776,785 B1	8/2004	Yencho et al.	
6,966,917 B1	11/2005	Suyker et al.	
7,018,387 B2	3/2006	Suyker et al.	
7,223,274 B2	5/2007	Vargas et al.	
2004/0172050 A1 *	9/2004	Bolduc et al.	606/153
2004/0186489 A1	9/2004	Lee	
2004/0215221 A1	10/2004	Suyker et al.	
2004/0249399 A1	12/2004	Cinquin et al.	
2005/0067454 A1 *	3/2005	Vresh et al.	227/19
2005/0149076 A1	7/2005	Borghi et al.	
2005/0182430 A1	8/2005	Schenck	
2005/0251179 A1	11/2005	Vargas	
2005/0288693 A1	12/2005	Suyker et al.	
2006/0004391 A1	1/2006	Haverich et al.	
2006/0004392 A1	1/2006	Amarant	
2006/0085017 A1	4/2006	Borghi	
2007/0049954 A1	3/2007	Caty et al.	
2007/0073317 A1	3/2007	Tanaka	
2007/0239180 A1 *	10/2007	Kuester et al.	606/153
2011/0152862 A1 *	6/2011	Brodbeck et al.	606/49

* cited by examiner

Primary Examiner — Brian D Nash

Assistant Examiner — Michelle Lopez

(74) *Attorney, Agent, or Firm* — Novak Druce + Quigg LLP

(57) **ABSTRACT**

A system for performing anastomosis includes a plurality of staples, an annular staple support having structure for holding the staples, and a staple closing device for closing the staples to secure the canal ends together. A method for performing anastomosis and staples for performing anastomosis are also disclosed.

12 Claims, 9 Drawing Sheets

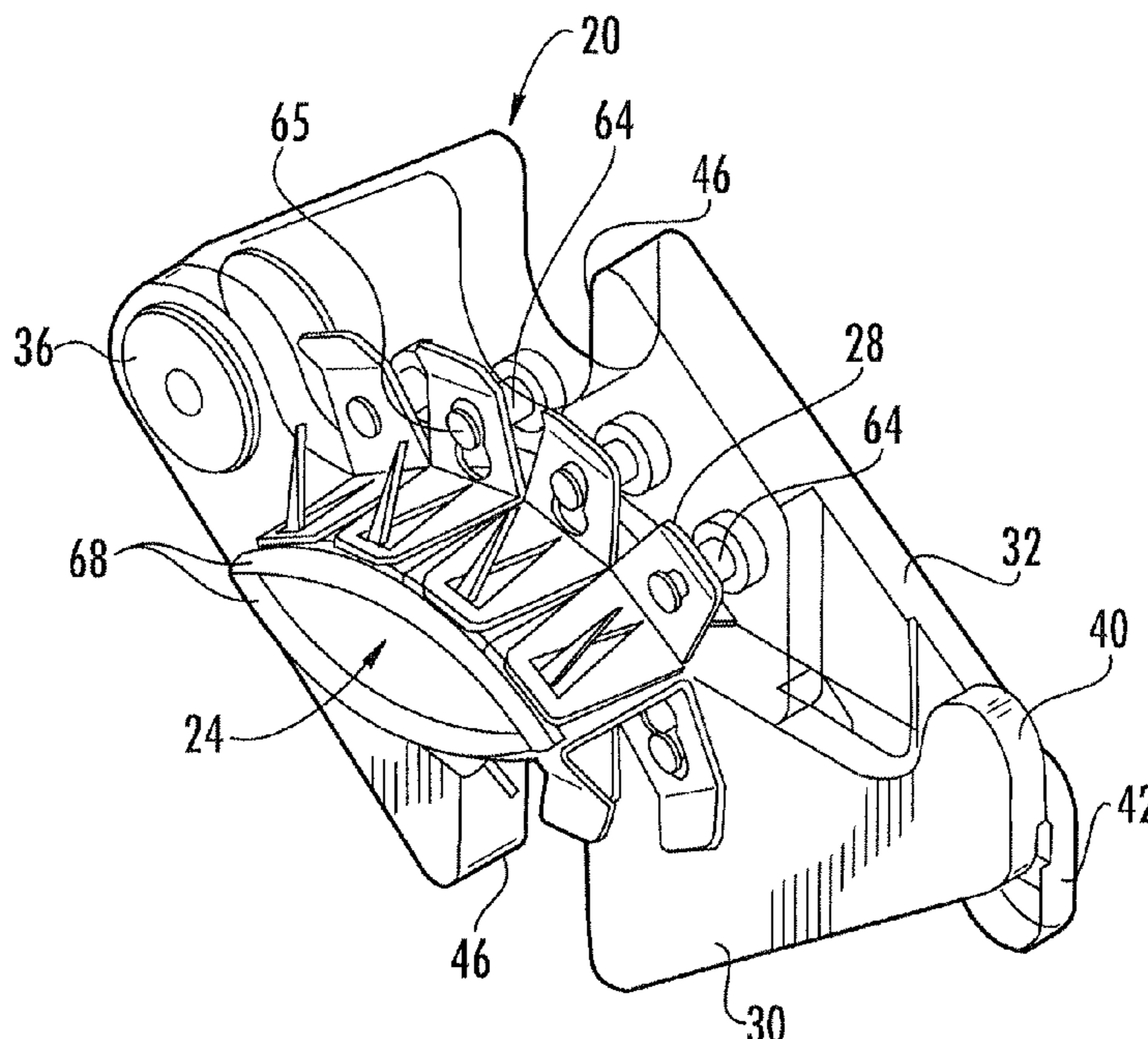

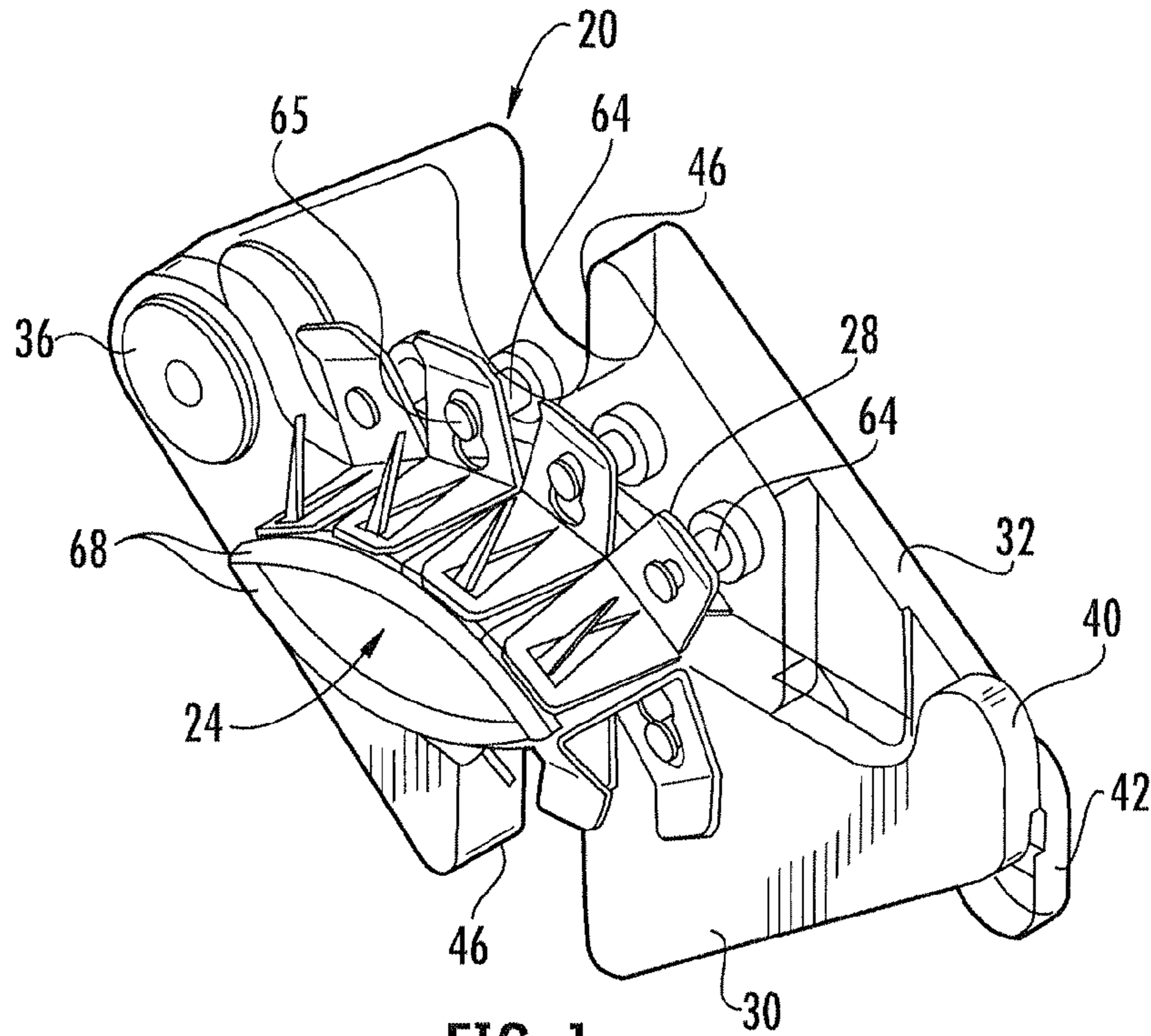

FIG. 1

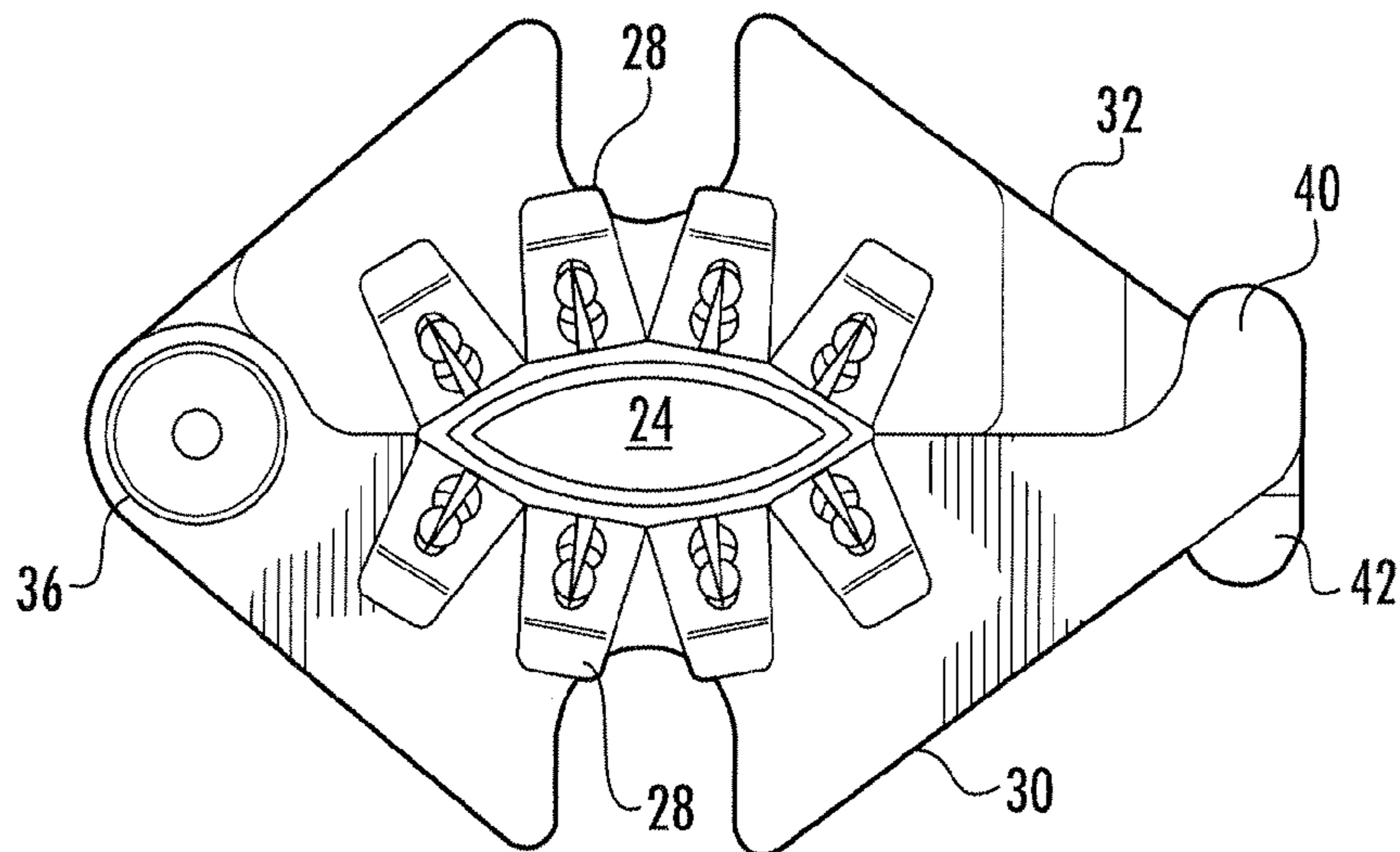

FIG. 2

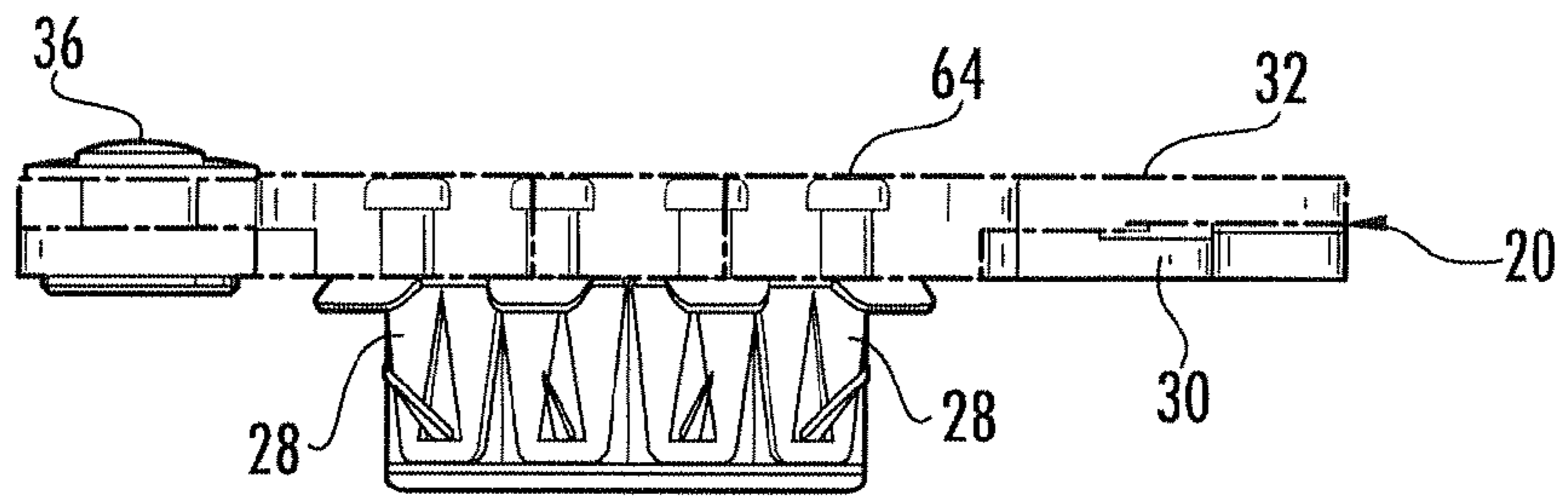

FIG. 3

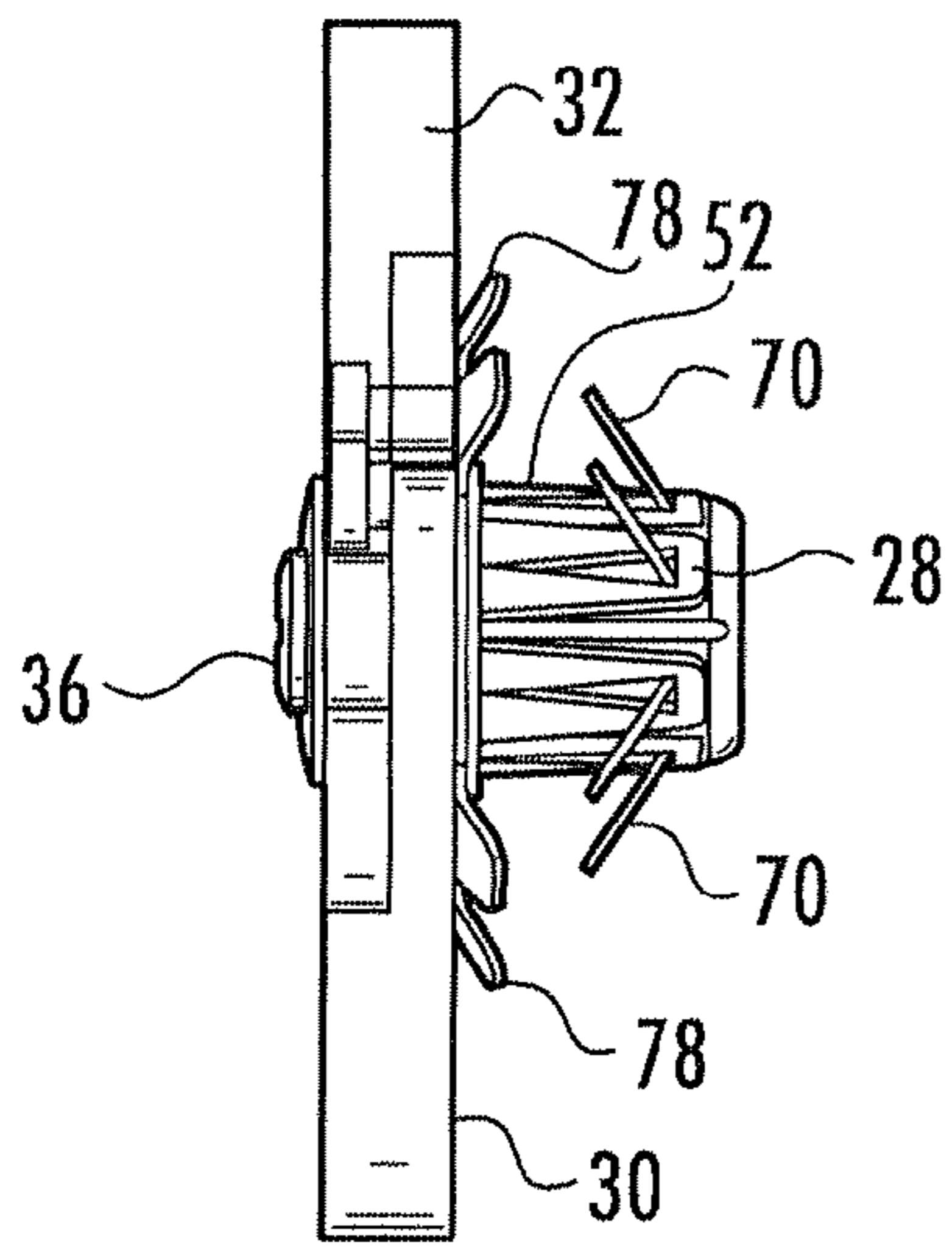

FIG. 4

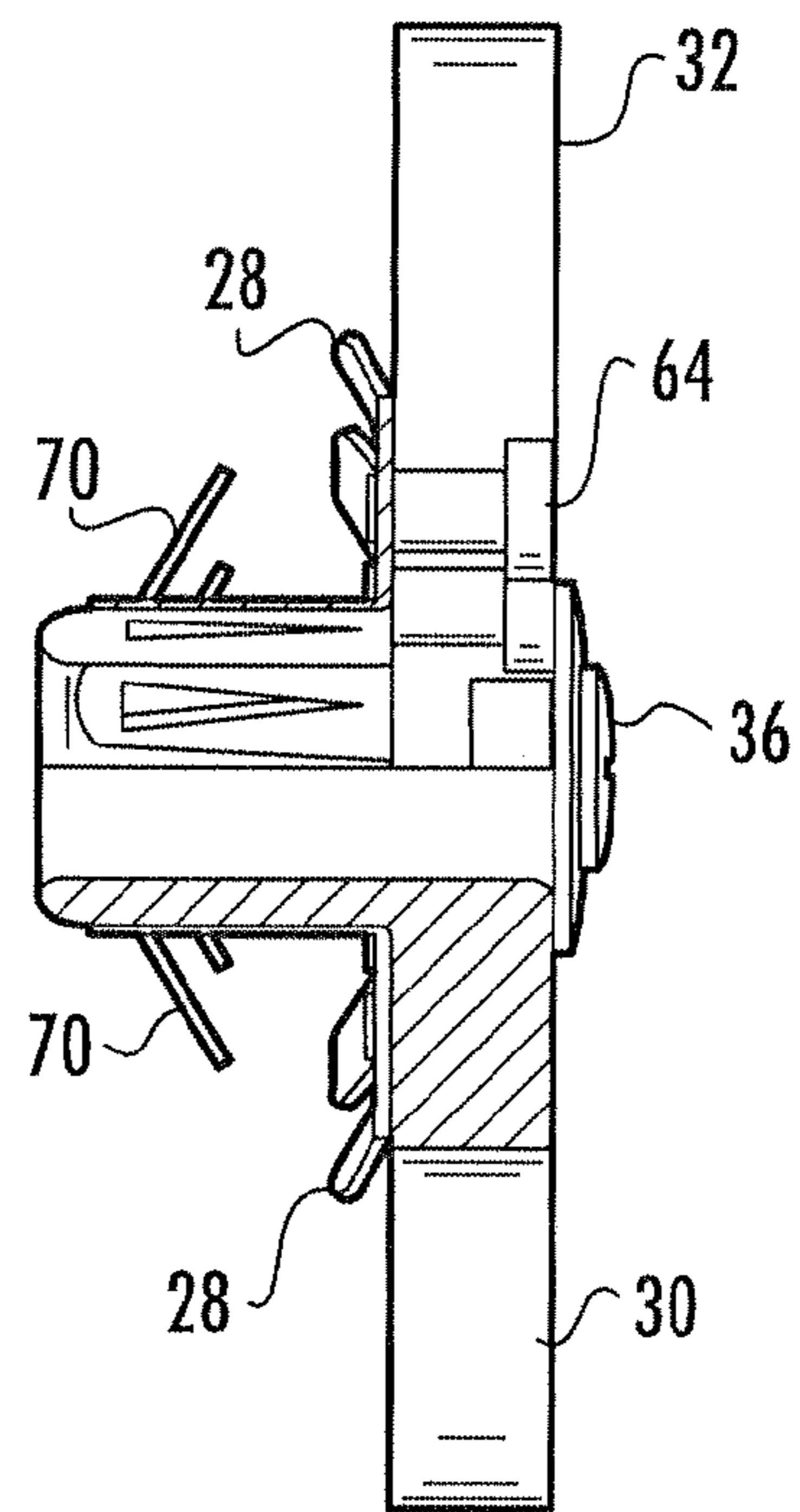
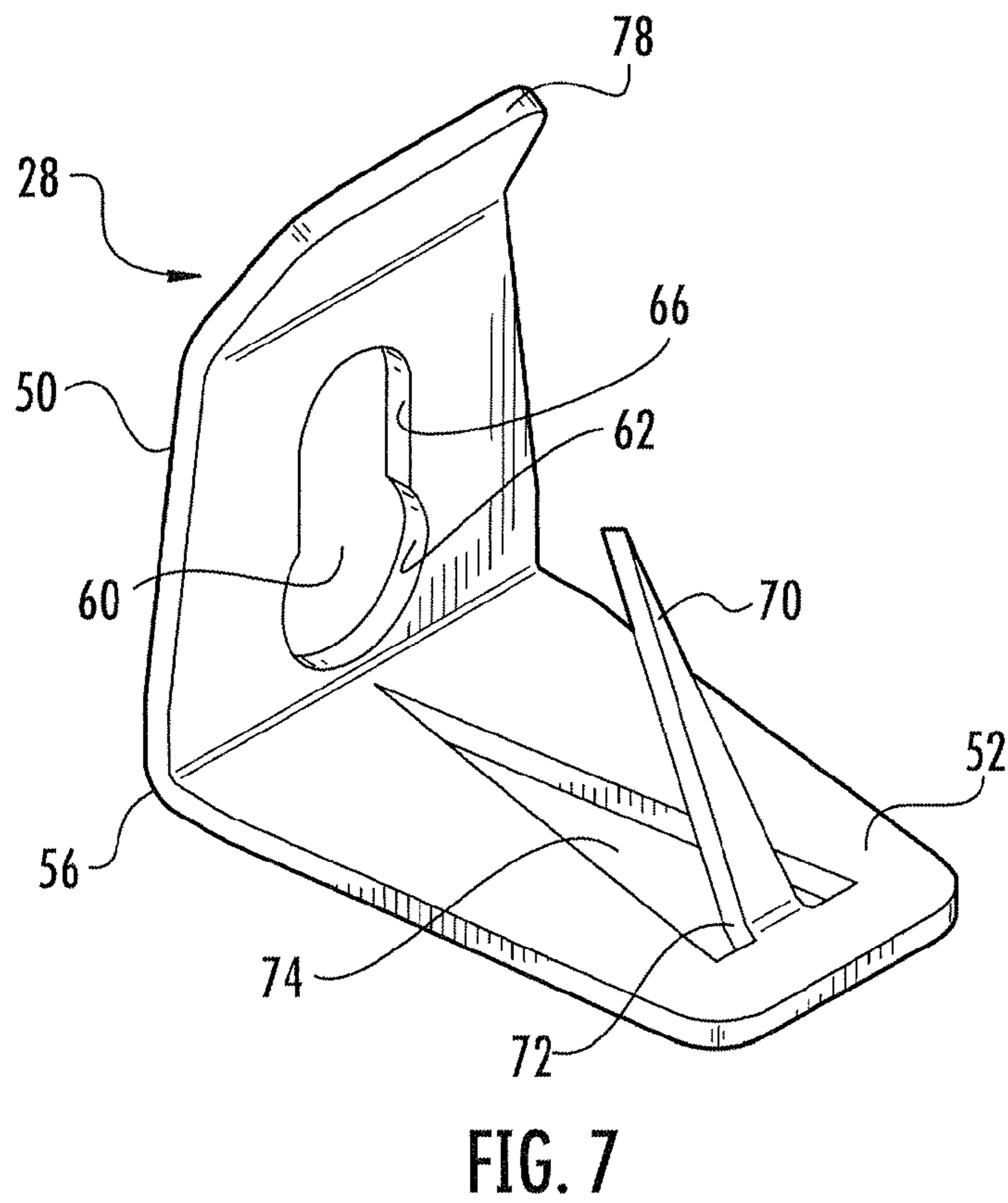
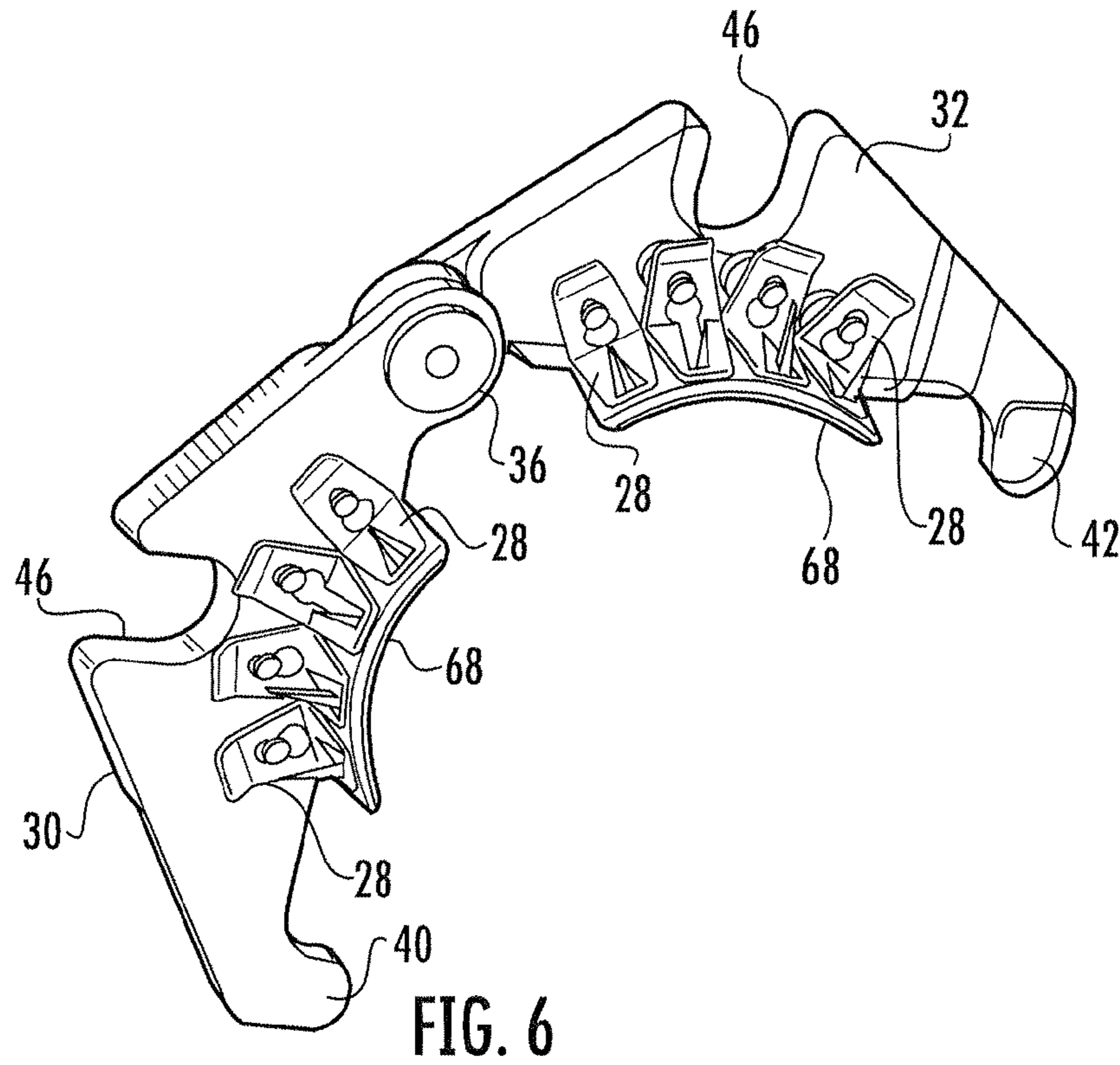

FIG. 5



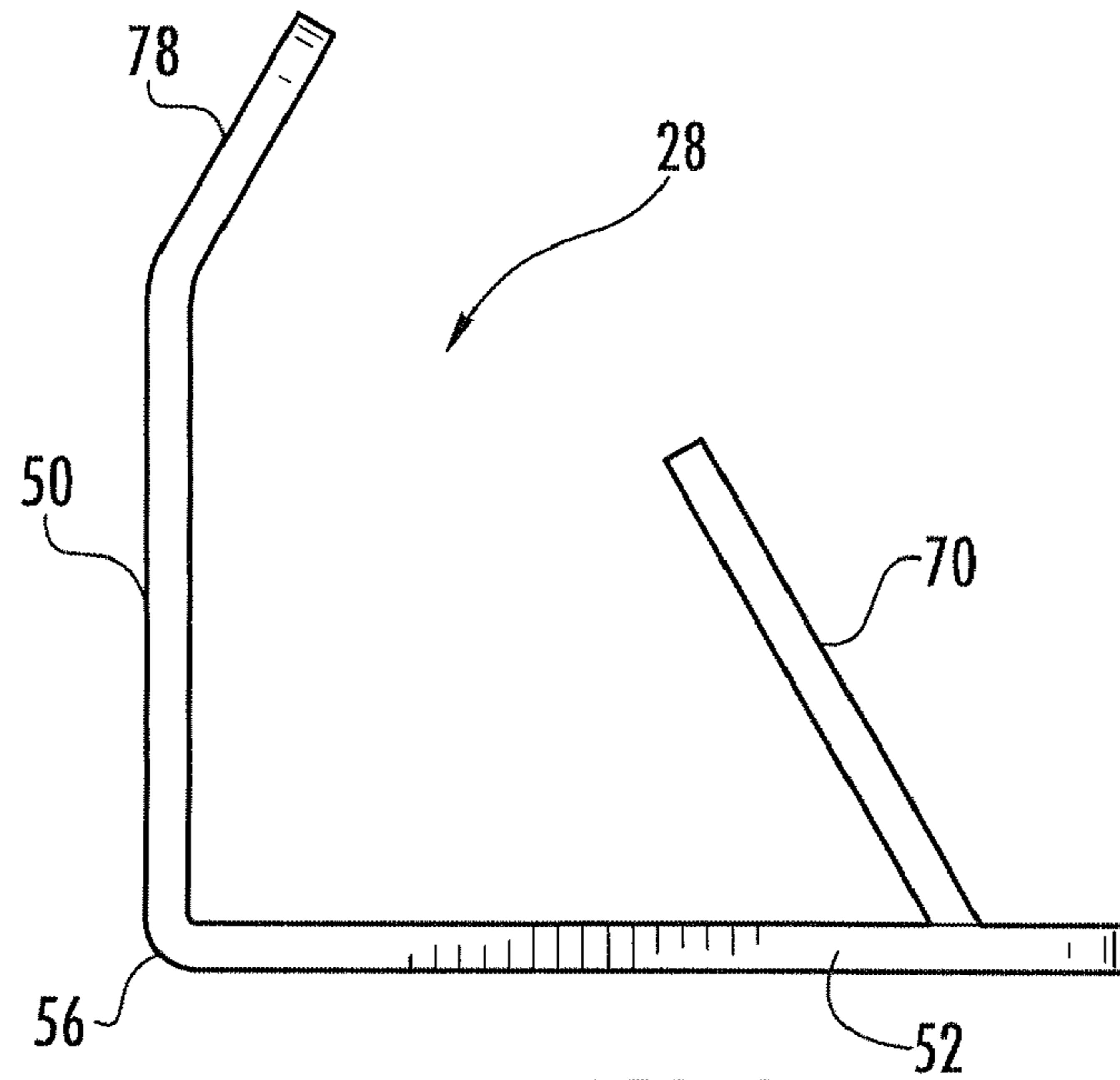

FIG. 8

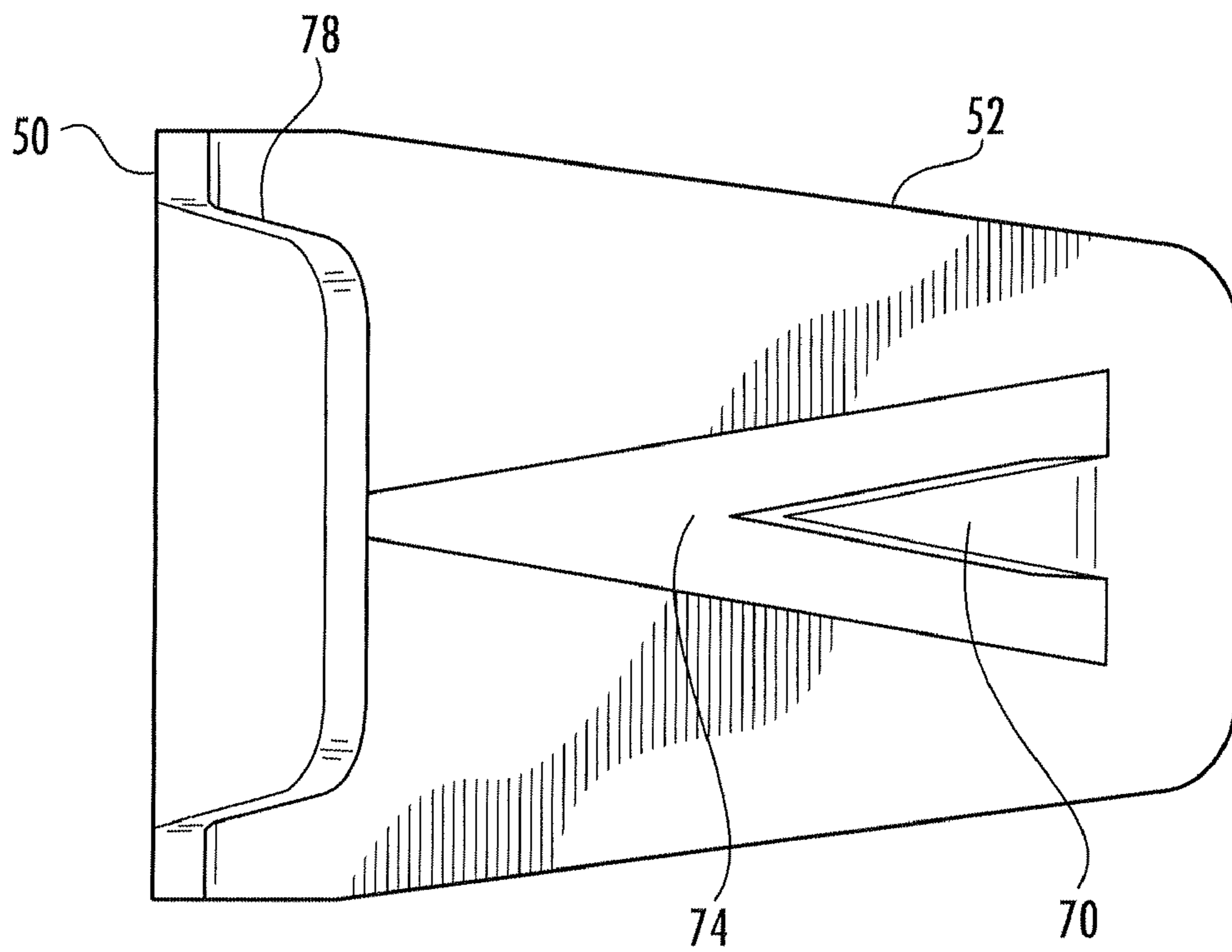

FIG. 9

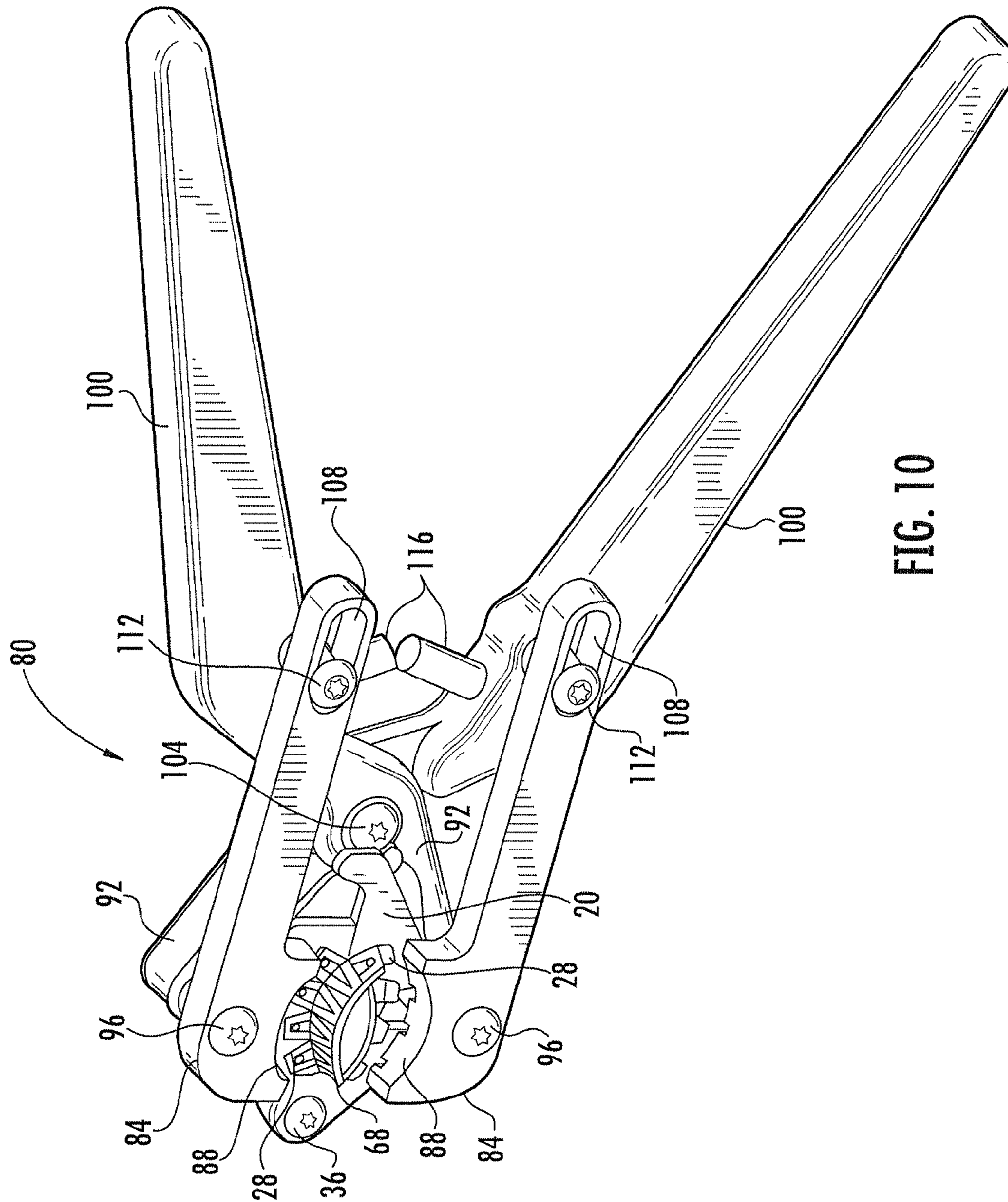

FIG. 10

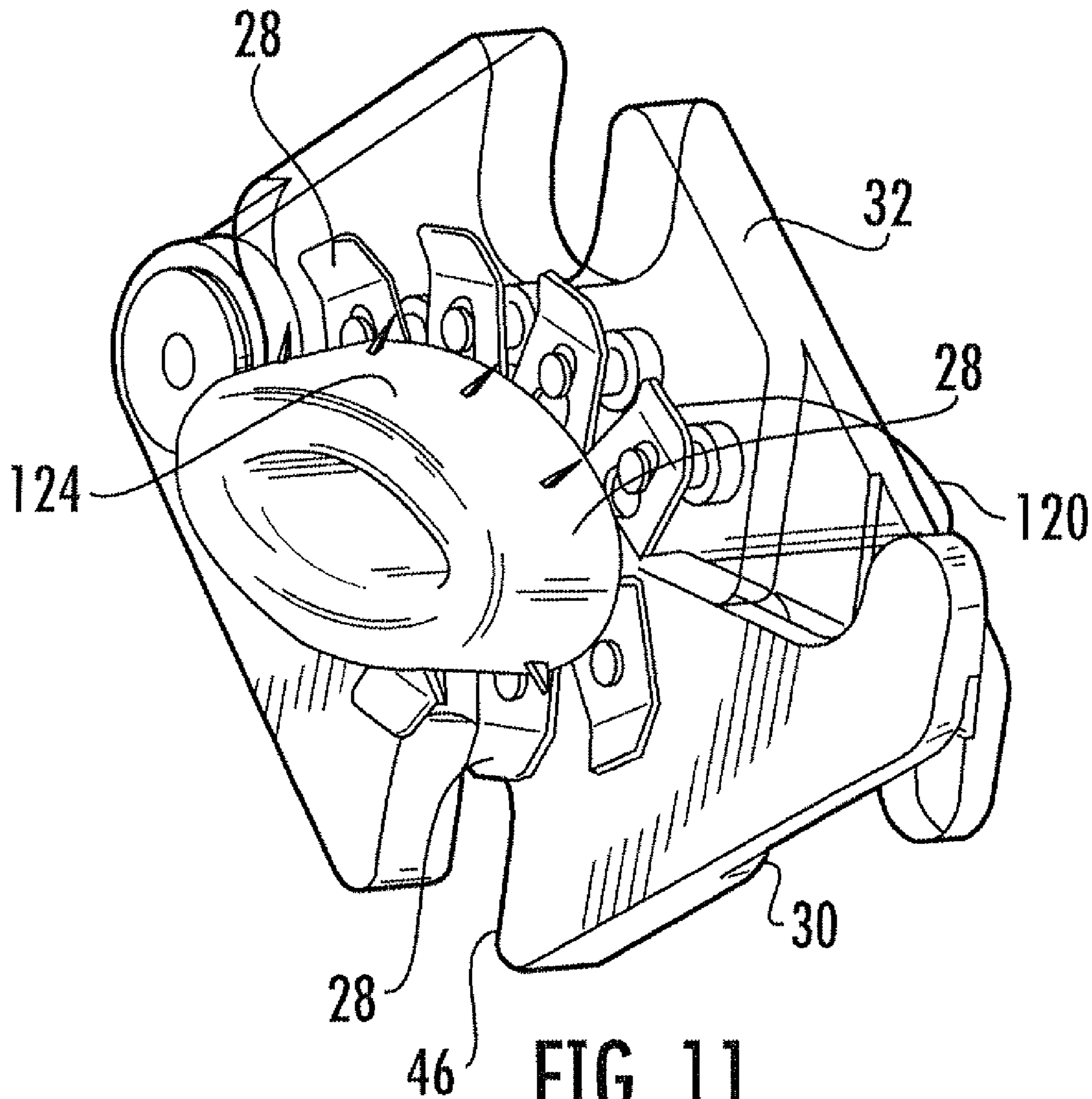

FIG. 11

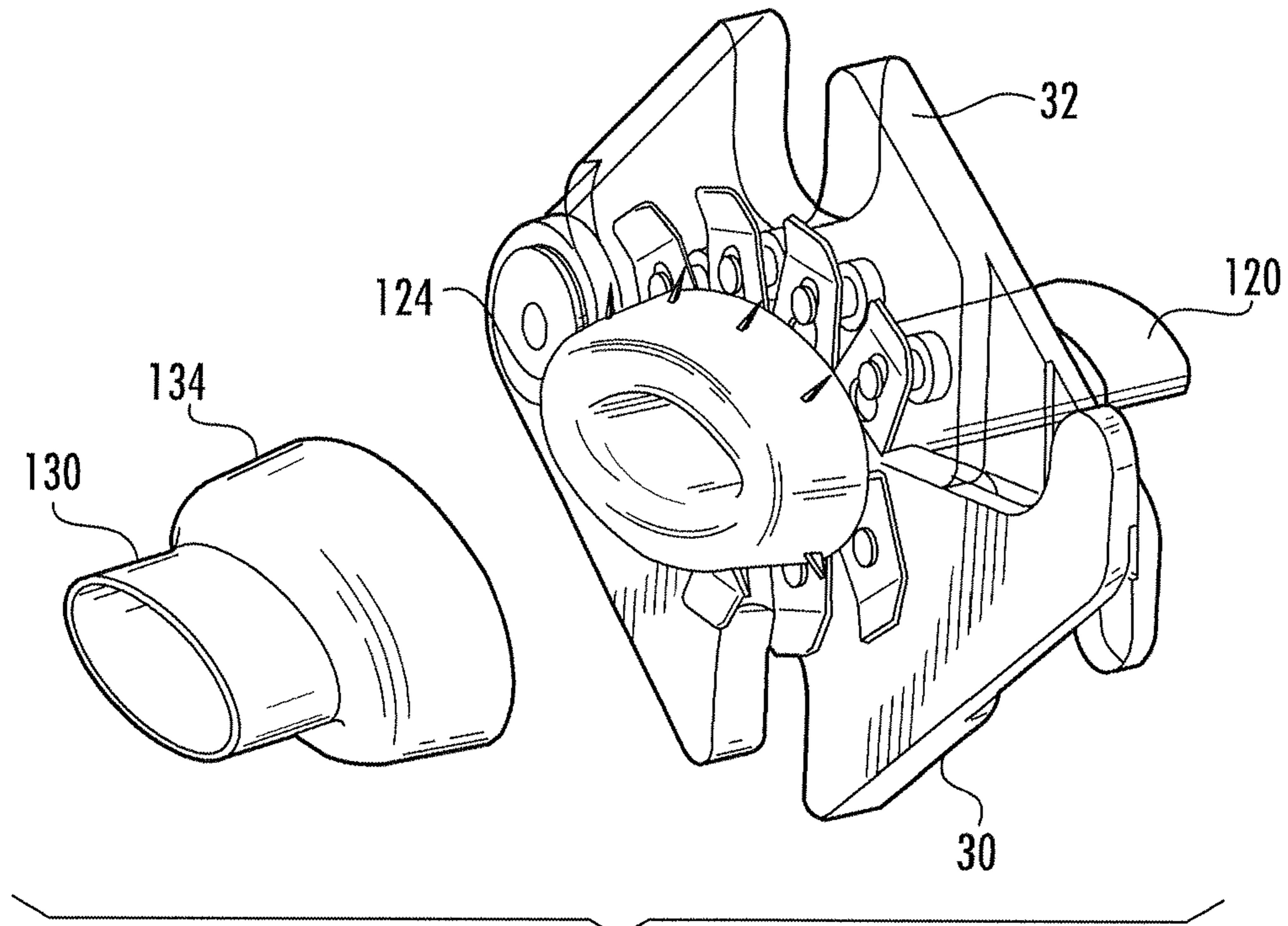

FIG. 12

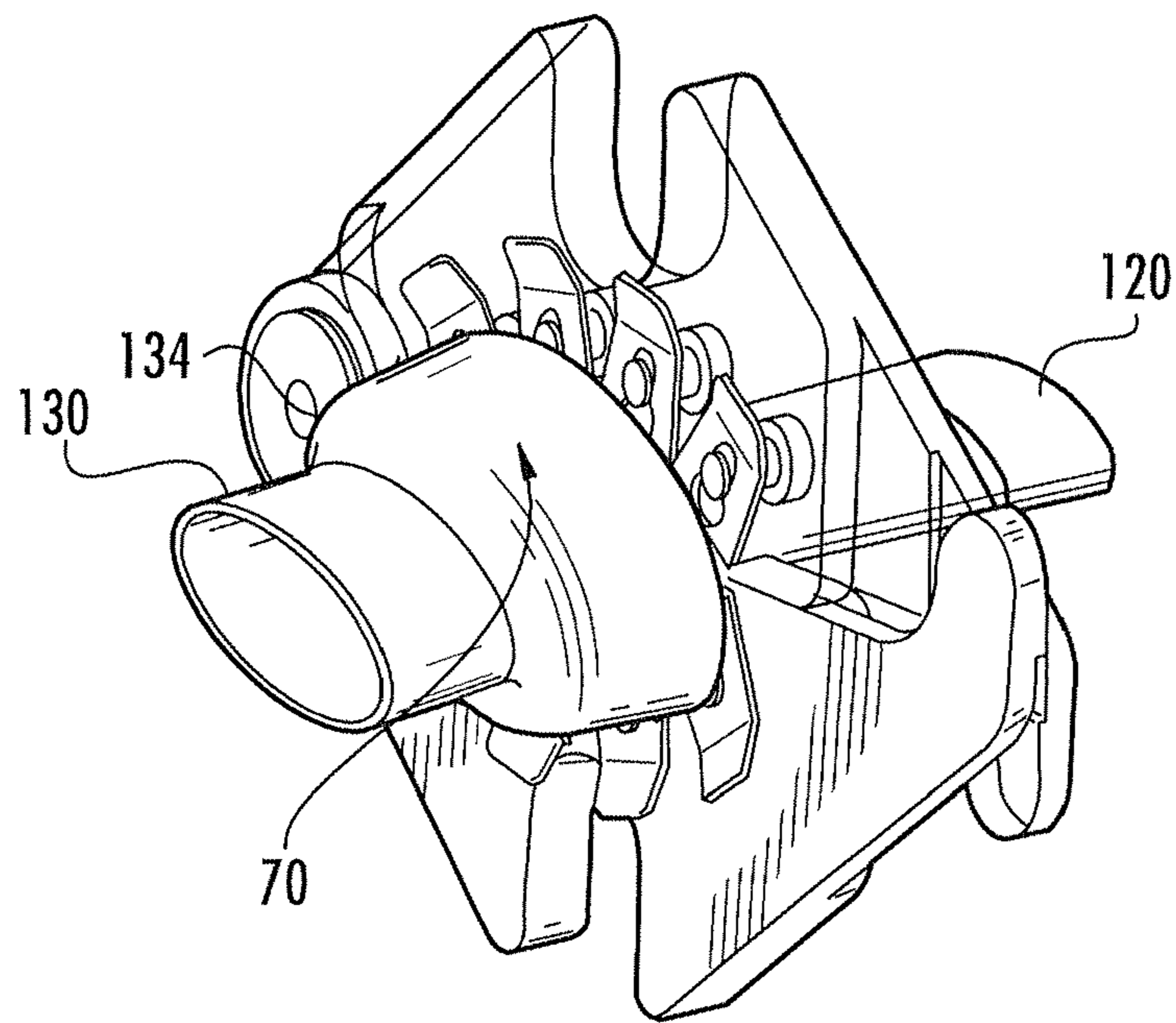

FIG. 13

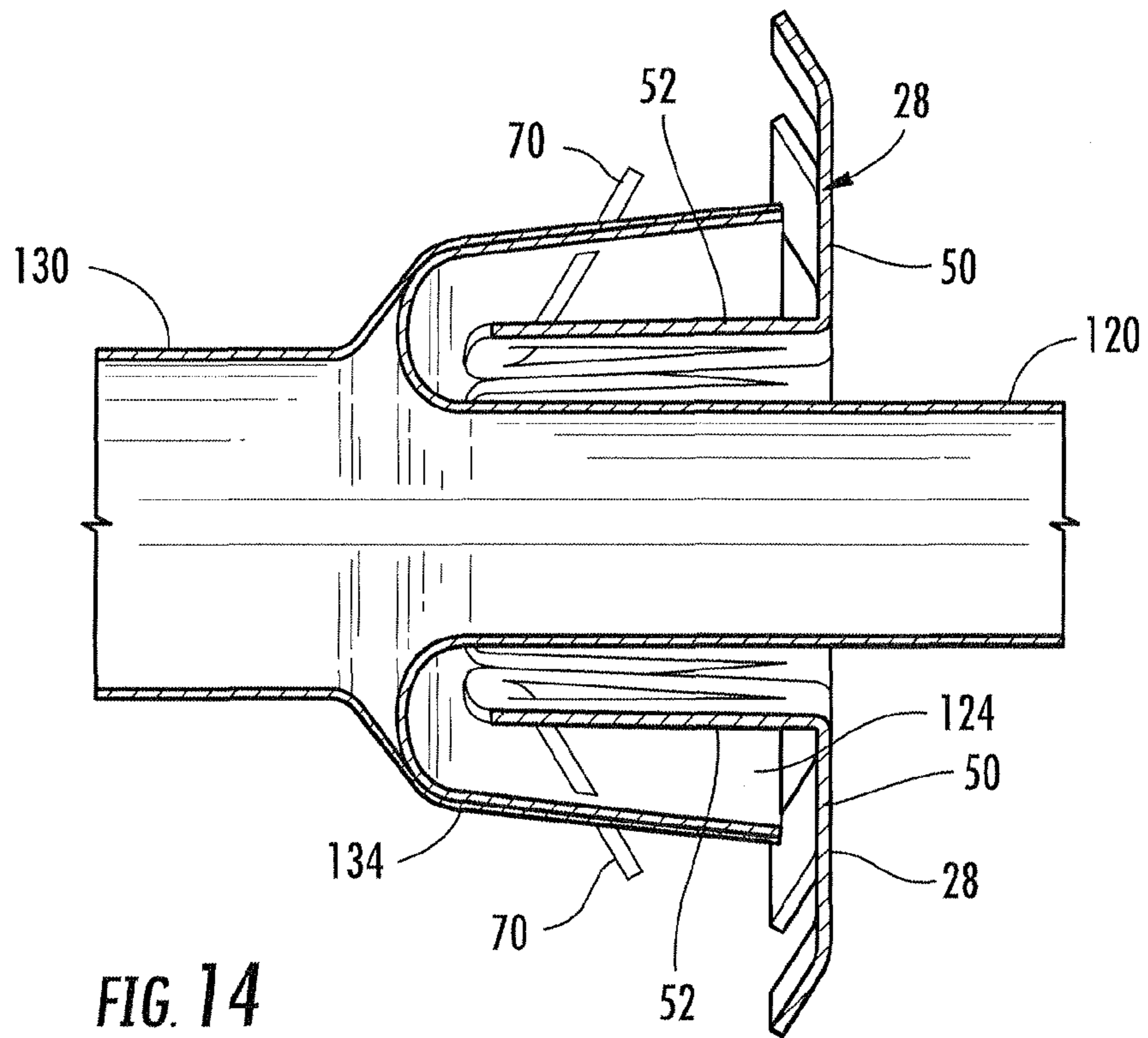

FIG. 14

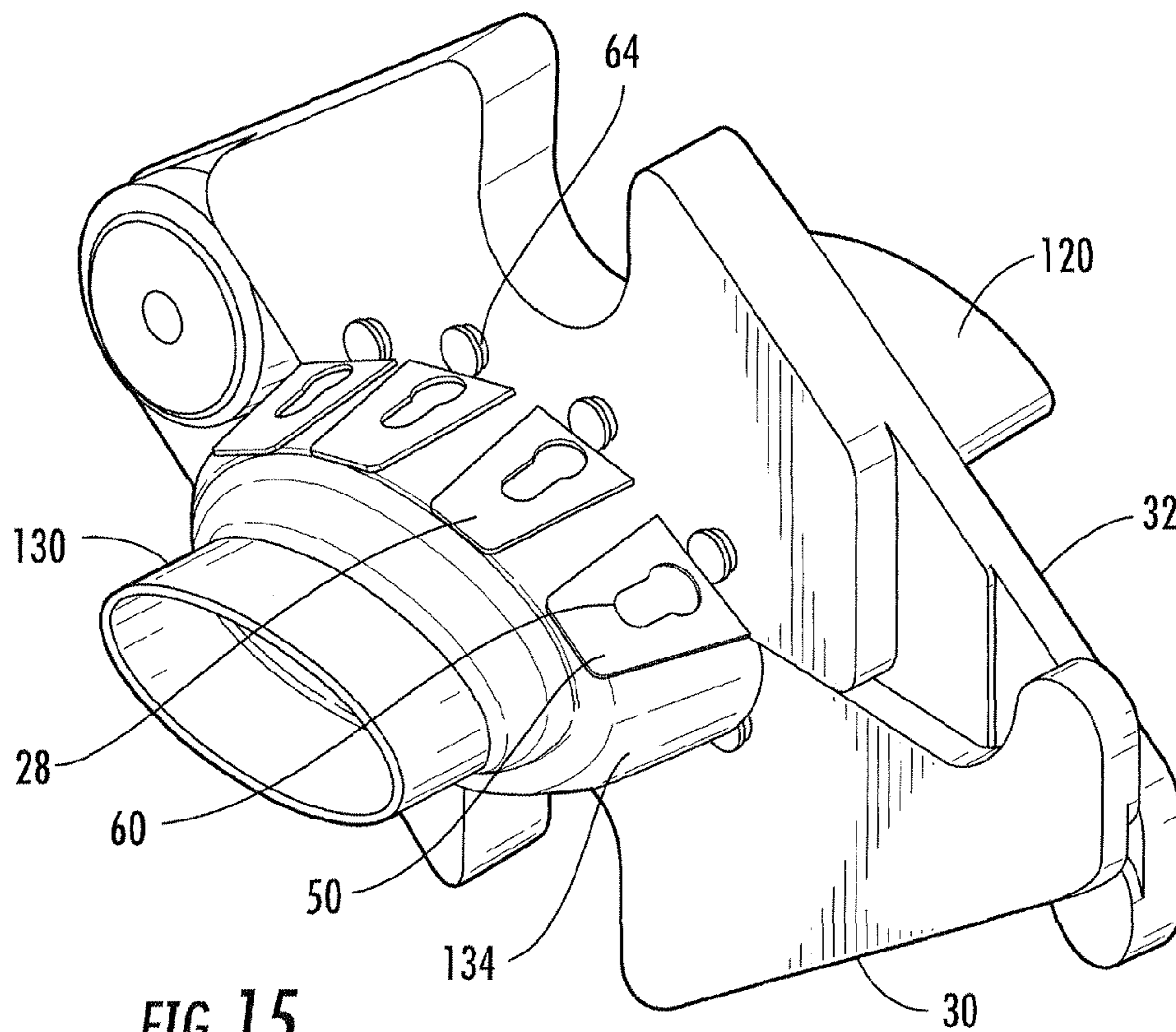

FIG. 15

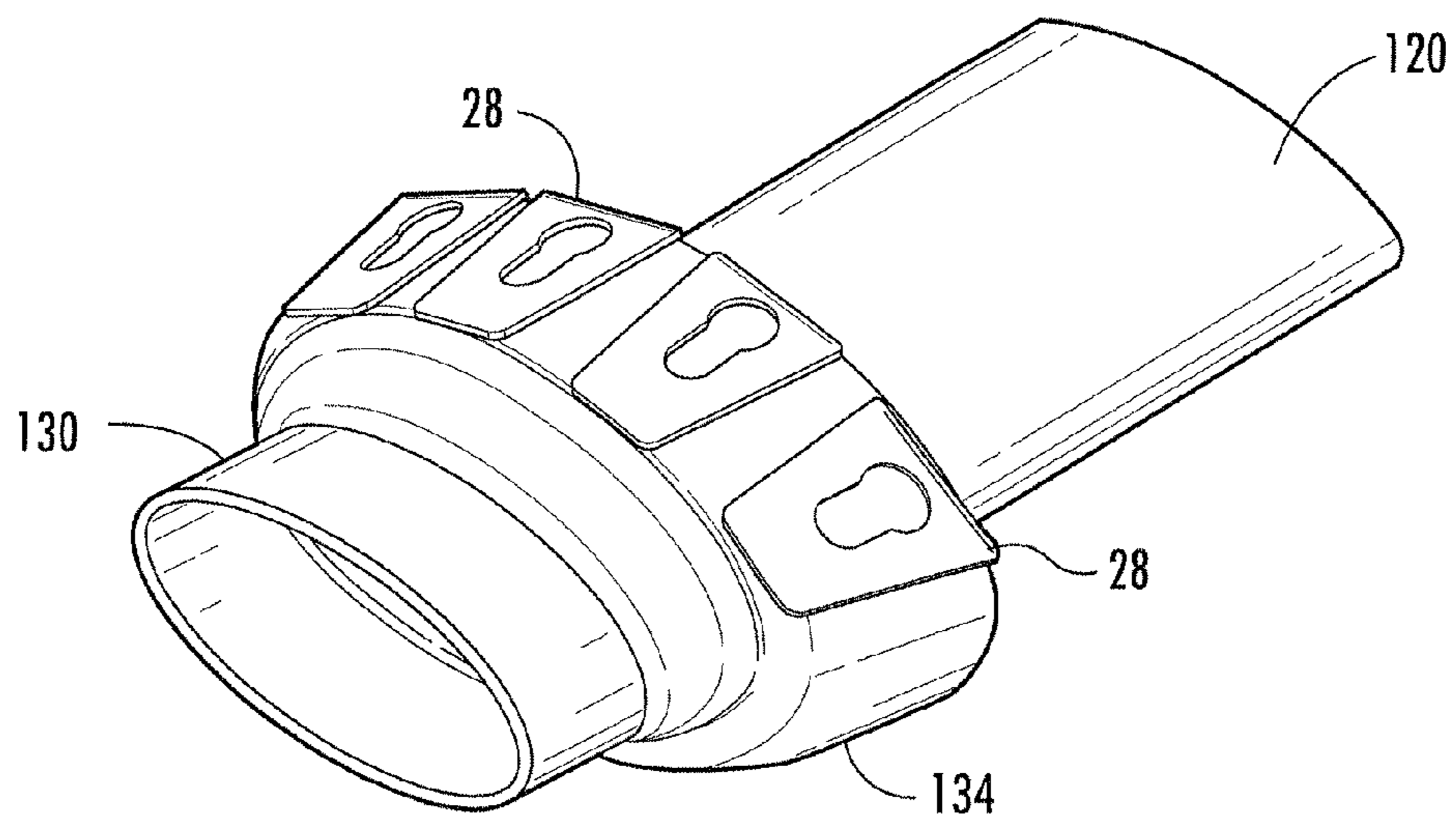

FIG. 16

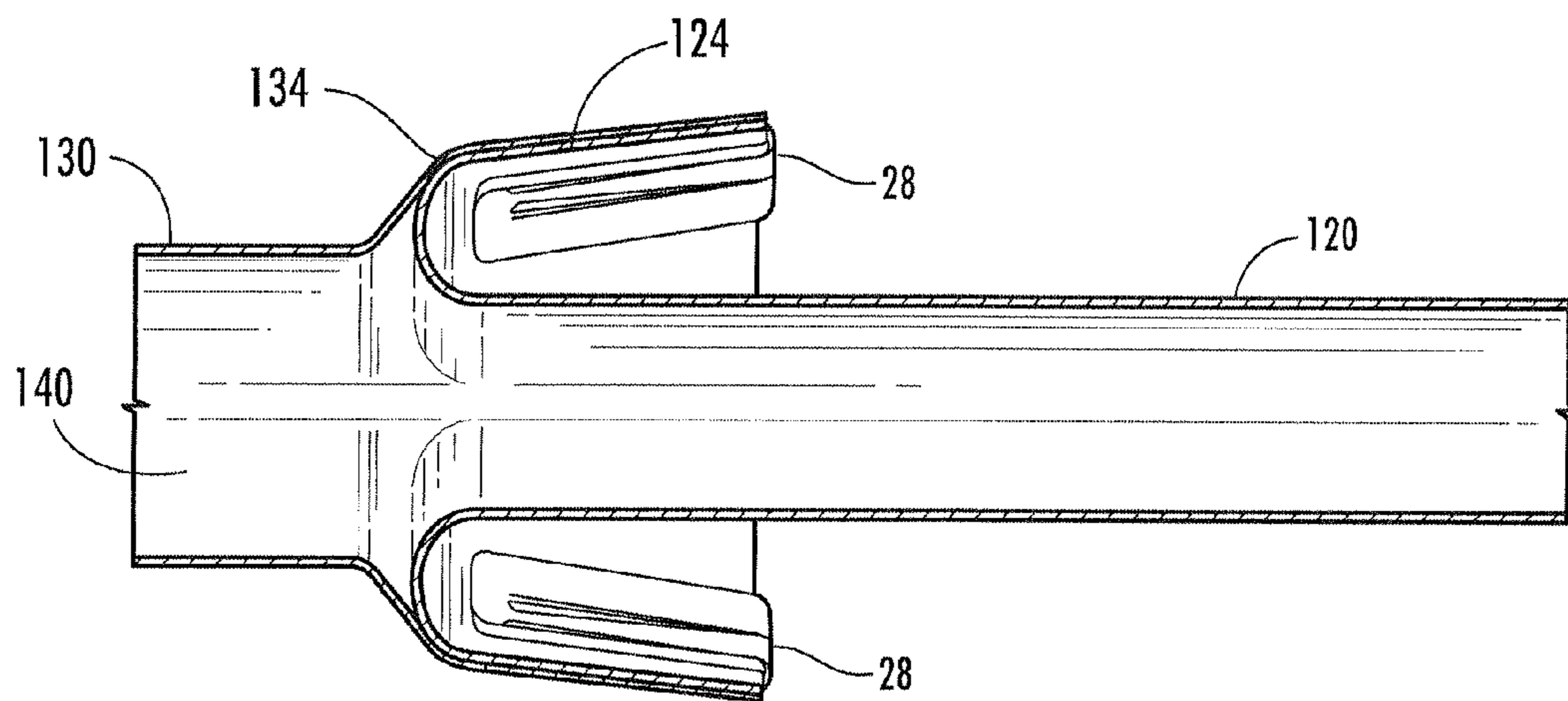

FIG. 17

ANASTOMOSIS SYSTEM AND METHOD

BACKGROUND OF THE INVENTION

Anastomosis is a surgical term for describing the joining of two hollow bodies, particularly blood and lymphatic vessels. Anastomosis can be end-to-end, as when the ends of a severed or damaged vessel are rejoined, or end-to-side, as when an end of a vessel is joined to the side of another vessel or hollow structure. The primary method for surgically anastomosing vessel ends has been the circumferential suture, in which a suture is hand applied around the ends of the two vessels. Circumferential suturing is a time consuming, exacting process. It is very important that the ends of the vessels be joined properly, as leakage or obstruction of the vessel lumen is possible, with potentially serious effects on the patient's health. The physical manipulation of the vessel that is necessary for circumferential suturing can also result in damage to the vessel ends, with resulting degradation of the anastomosed vessel.

Various mechanical methods have been proposed for performing end-to-end anastomosis without circumferential suturing. In one such method, mechanical anastomosis by eversion, the ends to be connected are turned inside out and then joined to each other by mechanical methods. Such techniques, however, have been known to damage the vessel walls or result in a reduced-flow lumen at the junction location.

SUMMARY OF THE INVENTION

A system for performing anastomosis includes a plurality of staples having an open and a closed position, and an annular staple support. The annular support defines an interior opening. The support holds the plurality of staples about the opening when the staples are in the open position, and releases the staples when the staples are in the closed position.

The annular staple support can have first and second annular portions, and engagement structure for securing the first and second annular portions together around a body canal. The engagement structure can include a hinge and/or a clasp. The support can have pins and the staples can have slots for engaging the pins to the staples. The slots can have a large diameter portion and a small diameter portion, and the pins can have a large diameter head. The head is smaller than the large diameter portion but larger than the small diameter portion, whereby the pin will retain the staple.

The annular portions can comprise ledge portions, where the ledge portions abut the staples when the staples are engaged to the support. A staple closing mechanism for closing the plurality of staples can be provided. The staple closing mechanism can have engagement surfaces which mate with the ledges of the support, whereby the staples will be closed simultaneously.

The staples can comprise at least one piercing projection. The staples can also comprise first and second sides connected at a junction to define an included space. The projection extends from one of the sides into the included space. The staples can have flexible portions permitting the sides to be moved toward one another.

The staples can be substantially circumferentially disposed in side-to-side alignment about the annular staple support. The closing mechanism can be a separate stapler device and can have a pair of jaws. Each of the jaws can comprise a concave portion dimensioned to substantially mate with a corresponding one of the annular portions.

A method for performing anastomosis can include the steps of: positioning an annular staple support defining an

interior opening around a first canal end with the first canal end extending at least partially into the opening, the support retaining a plurality of staples circumferentially disposed around the opening; folding the first canal end back over the staple support so as to engage the staples; positioning the second canal end over the folded-back first canal end and the staples; closing the staples over the first canal end and the second canal end and detaching said staples from the staple support; and removing the staple support.

A staple for performing anastomosis includes first and second staple portions joined together at ends thereof so as to define an included space. The first staple portion includes structure for engaging a staple support. The second staple portion includes structure for engaging a canal. The structure for engaging a canal can include a projection for piercing the canal, the projection extending into the included space. The structure for engaging a staple support can comprise a slot. The slot can have a large diameter portion and a small diameter portion.

BRIEF DESCRIPTION OF THE DRAWINGS

There are shown in the drawings embodiments that are presently preferred it being understood, however, that the invention is not limited to the precise arrangements and instrumentalities shown, wherein:

FIG. 1 is a perspective view of a staple support having a plurality of staples disposed thereon.

FIG. 2 is a front elevation.

FIG. 3 is a top plan view.

FIG. 4 is a side elevation.

FIG. 5 is a cross section.

FIG. 6 is a perspective view in an open configuration.

FIG. 7 is a perspective view of a staple according to the invention.

FIG. 8 is a side elevation.

FIG. 9 is a top plan view.

FIG. 10 is a perspective view of a stapling device positioned around the staple support and staples.

FIG. 11 is a perspective view of a first step of a method according to the invention.

FIG. 12 is a perspective view of a second step.

FIG. 13 is a perspective view of a third step.

FIG. 14 is a cross section further illustrating the third step.

FIG. 15 is a perspective view of a fourth step.

FIG. 16 is a perspective view of a body canal that has been anastomosed according to the invention.

FIG. 17 is a cross section of a body canal that has been anastomosed according to the invention.

DETAILED DESCRIPTION OF THE INVENTION

There is shown in FIGS. 1-6 an annular staple support 20 defining an opening 24. The staple support has structure for holding a plurality of staples 28 about the opening 24. The support 20 is positioned around the body canal with the body canal in the opening 24, and the support 20 is then removed from the body canal when the anastomosis has been completed. The support 20 can comprise two or more sections 30, 32 which can be connected and disconnected in some fashion to permit the placement or removal of the support 20 around a body canal. In the embodiment that is shown, the sections 30, 32 are pivotally joined at hinge pin 36 and secured by clasp members 40, 42. Other structure to connect and remove the support 20 from around the body canal is possible. Slots 46 or other structure such as protrusions can be provided to

facilitate engagement by a tool such as forceps or pliers to position the support **20** around the body canal.

The staples **28** are mounted to the support **20** such that they are retained on the support until they are engaged to the body canal during the anastomosis process. As shown in FIGS. 7-9, the staples **28** can have first and second sides **50**, **52** joined together at a junction **56** and define an included space between the sides. The sides **50**, **52** are shown joined at approximately a 90° angle, however other orientations are possible.

Structure is provided to secure the staples **28** to the support **20**. This structure can be provided on the support **20** or the staples **28**, and in the embodiment that is shown this structure is cooperating structure on the staples **28** and on the support **20**. At least one of the sides **50**, **52** of the staples **28** has structure for detachably engaging the support **20**. There are different structures that can be used to retain the staples **28** to the support **20**. In the embodiment that is shown, the first side **50** of the staples **28** has keyed grooves **60** with a large diameter portion **62** and a smaller diameter portion **66** which are adapted to detachably engage cooperating protrusions or pins **64** on the support **20**. The pins **64** can have a large diameter head **65** that is larger in diameter than the shaft of the pin, such that the head **65** will pass through the large diameter portion **62** but will not pass through the small diameter portion **66** of the grooves **60**. This will retain the staple **28** when is positioned over the small diameter opening **66**, as shown in FIG. 1. Other means for holding and releasing the staples, such as weak adhesives or alternative mechanical structures, are also possible.

The second side **52** of the staples **28** can be positioned adjacent ledge portions **68** of the support **20**. The ledge portions **68** can be provided adjacent the opening **24**. The ledge portions **68** can extend outwardly from the sections **30**, **32** and can be substantially curved so as to conform to the opening **24**. The ledge portions **68** provide a surface against which a force can be applied by the staple closing device to close the staples **28** and secure the ends of the body canal. The ledge portions **68** also serve to protect the body canal from damage during the anastomosis process. In one embodiment the ledge portions are substantially perpendicular to the sections **30**, **32**.

Each staple **28** has at least one projection for engaging the ends of the body canal. In one embodiment a piercing projection **70** is provided. The piercing projection **70** extends outwardly from one of the sides of the staple **28** such as the side **52** and extends toward the other side **50** such that when end portions of the body canal are placed between the sides **50**, **52** the projection **70** will pierce and engage the end portions. The projection **70** can be formed in any suitable construction, and can in one embodiment be cut or stamped from the side **52** and bent outward at seam **72** to leave opening **74**. Other configurations of the projection **70** are possible. More projections can be provided on a staple, and the projections can be positioned in different locations on the staple. Staples without projections are also possible.

A flange **78** can be provided at the free end of the side **50** to provide a surface which can be readily engaged by the staple closing device to close the staple **28** after the ends of the body canal have been engaged. The flange **78** will also serve to secure the tissue in the staple **28**. The flange **78** can be formed by bending a portion of the free end of side **50** toward the side **52**. Other structure for engaging the staple closing device is possible, for example, a protrusion formed on the staple surface.

The staples **28** can be closed around the ends of the body canal by any suitable means. A special purpose staple closing device can be provided to close the staples. The staple closing

device should preferably engage and close all of the staples in a single motion, in order to decrease the time required by the process and to provide a more even pressure around the canal during the anastomosis process. A suitable staple closing device **80** is shown in FIG. 10. The staple closing device **80** has a pair of cooperating jaws **84** with engagement surfaces **88**. The engagement surfaces **88** are preferably shaped to substantially mate with ledge portions **68** such that when jaws **84** are closed, the staples **28** will be closed between the engagement surfaces **88** and ledge portions **68**. The engagement surfaces **88** will engage the staples **28**, such as at the flanges **78**, to force the side **50** toward side **52** as the jaws **84** are closed. The staples **28** will thereby all be closed in the same motion, by a single operation of the staple closing device **80**.

The jaws **84** of the stapler **80** can be operated by any suitable driving mechanism, including electrical or mechanical drive system. The embodiment shown in FIG. 10 has a mechanical, hand-operated drive system. The jaws **84** are pivotally connected to drive arms **92** by suitable structure such as pivot pins **96**. The drive arms **92** can communicate with handles **100**. A hinge pin **104** or other suitable structure pivotally connects the handles **100** and drive arms **92** in a scissor like fashion, such that manipulation of the handles **100** will move the drive arms **92** toward each other. Slots **108** in jaws **84** are engaged by pins **112** to handles **100** to limit pivoting of the jaws about pivot pins **96**. Stops **116** can be provided on the handles **100** to limit movement of the handles **100**, and thus the jaws **84**, to a point which could result in damage to the staple **28**, support **20**, or body canal. It is also possible to construct an integrated staple support with a mechanism to close and release the staples, such that a separate stapler would not be necessary.

An example of a process of performing anastomosis according to the invention is shown in FIGS. 11-17. The support **20** is provided with staples **28** positioned on pins **64**, as shown in FIGS. 1-6. In FIG. 11 the sections **30**, **32** are positioned around a first body canal portion **120**. Slots **46** or other structure can be used to engage a tool to the support **20** to effect the placement and closing of the support **20** about a body canal. The free end **124** of the first body canal portion **120** is then folded back and engaged to the projections **70** or other engagement structure of the staples **28**. The free end **134** of a second body canal portion **130** is then brought into position (FIG. 12), and then placed over the free end **124** of the first body canal portion **120** (FIG. 13). The free end **134** of the second body canal portion **130** is also engaged to the projections **70** as shown in FIG. 14. The staples **28** are then closed, as by the staple closing device shown in FIG. 10, which will force the staples **28** from the pins **64**. This will secure the free end **124** of the first body canal portion **120** and the free end **134** of a second body canal portion **130** together, as shown in FIG. 15. The closing of the staples **28** can be substantially simultaneous, and accomplished by suitable structure such as the staple closing device **80**. The support **20** can then be removed from its position around the body canal, as but disengaging the clasps **40**, **42**.

As shown in FIG. 16, the completed anastomosis junction site **144** has a profile which is comparable to that produced by currently used, more time-consuming anastomosis techniques, and will not interfere with repositioning the canal within the body. The completed anastomosis is depicted in FIG. 17 in cross section, where it is seen that the lumen **140** at the anastomosis site is substantially unchanged following the procedure.

The support **20** and staples **28** can be made in a variety of different sizes and shapes depending on the anastomosis pro-

5

cedure that is to be performed. The position of the ledge portions **68** and staples **28** must be such that the staples **28** are properly positioned adjacent the body canal so as to circumferentially engage the ends of the body canal. Smaller staples **28** allow more staples to be used, although more or fewer staples than those that are shown are possible.

This invention can be embodied in other specific forms without departing from the spirit or essential attributes thereof, and reference should be made to the appended claims, rather than to the foregoing specification, as indicating the scope of the invention.

We claim:

1. A system for performing anastomosis on opposing free ends of a body canal, comprising:

a plurality of staples having first and second opposing sides joined together at a junction and defining an included space between the sides, the staples having an open and a closed position; and

an annular staple support comprising first and second annular portions, said annular support defining an interior opening, said support holding said plurality of staples about said opening when said staples are in the open position, wherein the annular portions comprise annular ledge portions for surrounding a body canal positioned in the interior opening, the staples in the open position being circumferentially arranged and secured to the staple support such that one side of each staple abuts an adjacent portion of a ledge and the other side of the staple extends laterally outward from the ledge, whereby a first free end of the body canal can be positioned in the included space between the first and second sides when the staples are in the open position, folded back over itself and over the side of the staple adjacent the ledge, and when the staples are moved to the closed position by a staple closing mechanism the free ends of the body canal will be clamped between the opposing sides of the staples and the staples are released from the support.

2. The system of claim **1**, further comprising engagement structure for securing said first and second annular portions together around a body canal.

3. The system of claim **2**, wherein said engagement structure comprises a hinge.

4. The system of claim **3**, wherein said engagement structure comprises a clasp.

5. The system of claim **1**, wherein said support comprises pins and said staples comprise slots for engaging said pins to said staples.

6

6. The system of claim **1**, wherein said staple closing mechanism comprises engagement surfaces which mate with said ledges of said support, whereby said staples will be closed simultaneously.

7. The system of claim **1**, wherein said staples comprise at least one piercing projection for retaining ends of the body canal in the included space until the staples are closed and released from the support.

8. The system of claim **7**, wherein said projection extends from one of said sides into the included space.

9. The system of claim **8**, wherein said staples comprise flexible portions permitting said sides to be moved toward one another.

10. The system of claim **1**, wherein said staples are substantially circumferentially disposed in side-to-side alignment about said annular staple support.

11. A system for performing anastomosis, comprising: a plurality of staples having an open and a closed position; and

an annular staple support, said annular support defining an interior opening, said support holding said plurality of staples about said opening when said staples are in the open position, and releasing said staples when said staples are moved to the closed position by a staple closing mechanism, wherein said support comprises pins and said staples comprise slots for engaging said pins to said staples, said slots comprising a large diameter portion and a small diameter portion, and said pins comprising a large diameter head, said head being smaller than said large diameter portion but larger than said small diameter portion, whereby said pin will retain said staple.

12. A system for performing anastomosis, comprising: a plurality of staples having an open and a closed position; and

an annular staple support, said annular support defining an interior opening, said support holding said plurality of staples about said opening when said staples are in the open position, and releasing said staples when said staples are moved to the closed position by a staple closing mechanism; said staple closing mechanism comprising a pair of jaws, each of said jaws comprising a concave portion dimensioned to substantially mate with a corresponding portion of said annular support.

* * * * *